

LED replacement bulbs for flashlight

— P13.5 bulb base



I. Basic Feature

1. It is much brighter than the original incandescent globe. As the most energy-saving lighting, it is lower power-consumption.
2. LED bulb is characterized by solid state lighting and eco-friendly product with no hazardous substances.
3. The lifespan of LED bulbs is over 50,000 hours.
4. It is convenient to replace the LED flashlight bulbs with various optional bulb colors to meet special occasions.
5. Adjustable to the standard P13.5 bulb holder. And it works better as a direct replacement of incandescent bulb on flashlight.
6. Deshun's LED bulbs are set inside high efficient LED constant drivers to ensure full electricity transmission.
7. Deshun's LED bulbs are set inside wide-ranging voltage LED constant drivers to adjust to different voltages flashlight, and assure the brightness steady. They are safe, stable, and reliable.

Deshun's bulbs are added into more practical functions:

1. The bulbs' heat is automatically varied with the bulb temperature. When the bulb's heat increase to some degree, the temperature control circuit will display its function and control the highest temperature within the safety scope. Of course, the intensity will be decreased at the same time.
2. Reverse Polarity Protection Circuit has been built in the LED bulbs, so even if the power supply is connected reversely the positive and negative of power supply, the LED bulb will not be damaged.



II. Outline

0.5W Flashlight LED bulb



1W / 3W Flashlight LED bulb



Chinese LED bulb



Luxion LED bulb



Cree LED bulb



Side emitting LED bulb

III. Size

Standard size

| | |
|----------------------------|----------|
| A: Overall dimension | 24. 80mm |
| B: Lens to top flange | 9. 80mm |
| C: The bottom to upper cap | 22. 20mm |
| D: Diameter of upper cap | 9. 80mm |

Optional Size

We offer below size, and you can also specify your own ones.

| | |
|----------------------------|----------|
| A: Overall dimension | 23. 30mm |
| B: Lens to top flange | 8. 30mm |
| C: The bottom to upper cap | 20. 30mm |
| D: Diameter of upper cap | 9. 80mm |

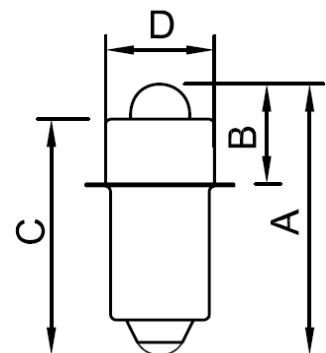



Model with parameter

| Model | Bulb holder | Working Voltage (V) | LED Power (W) | Intensity (LM) | Light Angle | LED Type |
|------------------|-------------|-----------------------|-----------------|----------------|-------------|----------|
| D109K2-0.5WCN35 | P13.5 | 1.0~9.0 | 0.5 | 35 | 120 | CN |
| DS109K2-1WCN75 | P13.5 | 1.0~9.0 | 1 | 75 | 120 | CN |
| DS109K2-1WCN100 | P13.5 | 1.0~9.0 | 3 | 100 | 120 | CN |
| DS630K2-1WCN75 | P13.5 | 6.0~30.0 | 1 | 75 | 120 | CN |
| DS630K2-1WCN100 | P13.5 | 6.0~30.0 | 3 | 100 | 120 | CN |
| DS0842K2-3WCN150 | P13.5 | 0.8~4.2 | 3 | 150 | 120 | CN |
| DS3209K2-3WCN150 | P13.5 | 3.2~9.0 | 3 | 150 | 120 | CN |

Recommend Application Schematics:

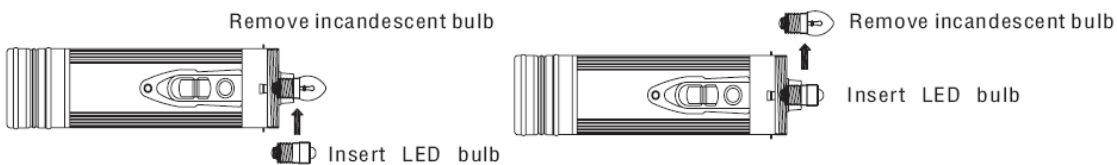

Remarks:

If there are some difference with above specifications and parameters, please taking objects as standard

IV. Major Concerns

1. Operating temperature: -30°C~+60°C
2. Storage temperature: -40°C~+85°C
3. Humidity: 5%~90%
4. It features brighter on the high heat-emitting flashlight.

V. Typical Applications:

- Portable lighting
- Flashlights
- Head Lamps
- Lanterns
- Ceiling Light

VI. Package